

Product Introduction

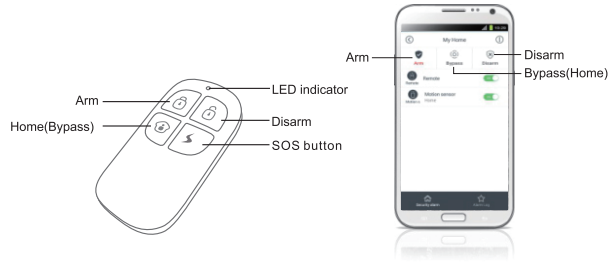

The remote control is easy to carry, it can be used to set the system to Arm/Disarm/Home or activate an alarm at touch of the SOS button. You can also remote arm/disarm/bypass the system using smartphone APP.

Arm: All zones/sensors are armed

Disarm: All zones / sensors are under the disarmed status, except the zones / sensors which is under 24-hours Arm mode.

Home (bypass): All the zones/sensors are armed except the home mode sensors.

Specifications

Easy to carry, four independent function keys

4 keys: Arm, Disarm, SOS, Home

Wireless transmitting distance: ≤80m (260 feet) in an open area

Transmitting frequency: 433.92MHZ

Operating voltage: 3V DC (1*CR2032 battery)

Operating current: 1uA (standby), 15mA (Transmitting)

Working temperature: -20°C~+50°C (-4°F~+122°F)

Working humidity: ≤85%

Add/Delete/Edit Accessories

Add Accessories

Method 1: Short press the pairing button on the hub to enter pairing mode, activate the accessory and succeeded with a beep.

Method 2: Start pairing mode from APP, activate the accessory and succeeded with a beep.

Edit/Delete Accessories

Long press the accessories name on your smartphone, then you can edit the accessories' mode, type, name, or delete the accessories.

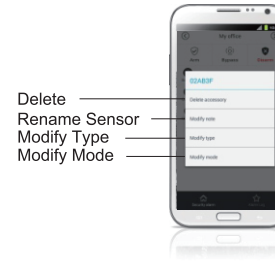

1) The hub will recognize remote and doorbell button automatically, the other sensors you should edit the type after added.

2) You could rename the enrolled sensor to get a user-defined alert

3) You could disable/enable each sensor anytime anywhere

4) There are four modes for each sensor:

Normal: In arm mode, when normal sensors are triggered, system will alarm. In disarm mode, when normal sensors are triggered, system will not alarm.

Home (bypass): In home mode, only normal sensor will be triggered and home sensors will not be triggered while alarming, this will allow user to move freely at home.

24 hour: Regardless the system is armed or disarmed, when 24 hour sensors are triggered, system will alarm at once.

Delay: In arm mode, when delay sensors are triggered, system will alarm after the entry delay time you have set.

⚠ ATTENTION: This product is only compatible with the following Zemgo Receivers: ZEM-1000, ZEM-1001 and ZEM-1001.